

Steering column switches, servicing

CAUTION!

Before beginning repairs on the electrical system:

- ◆ **Obtain the anti-theft radio security code.**
- ◆ **Switch the ignition off.**
- ◆ **Disconnect the battery Ground (GND) strap.**
- ◆ **After reconnecting battery, re-code and check operation of anti-theft radio. Also check operation of clock and power windows according to Repair Manual and/or Owner's Manual.**

Note:

Additional information on installing steering column

⇒ *Repair Manual
Suspension, Wheels,
Brakes, Steering,
Repair Group 48*

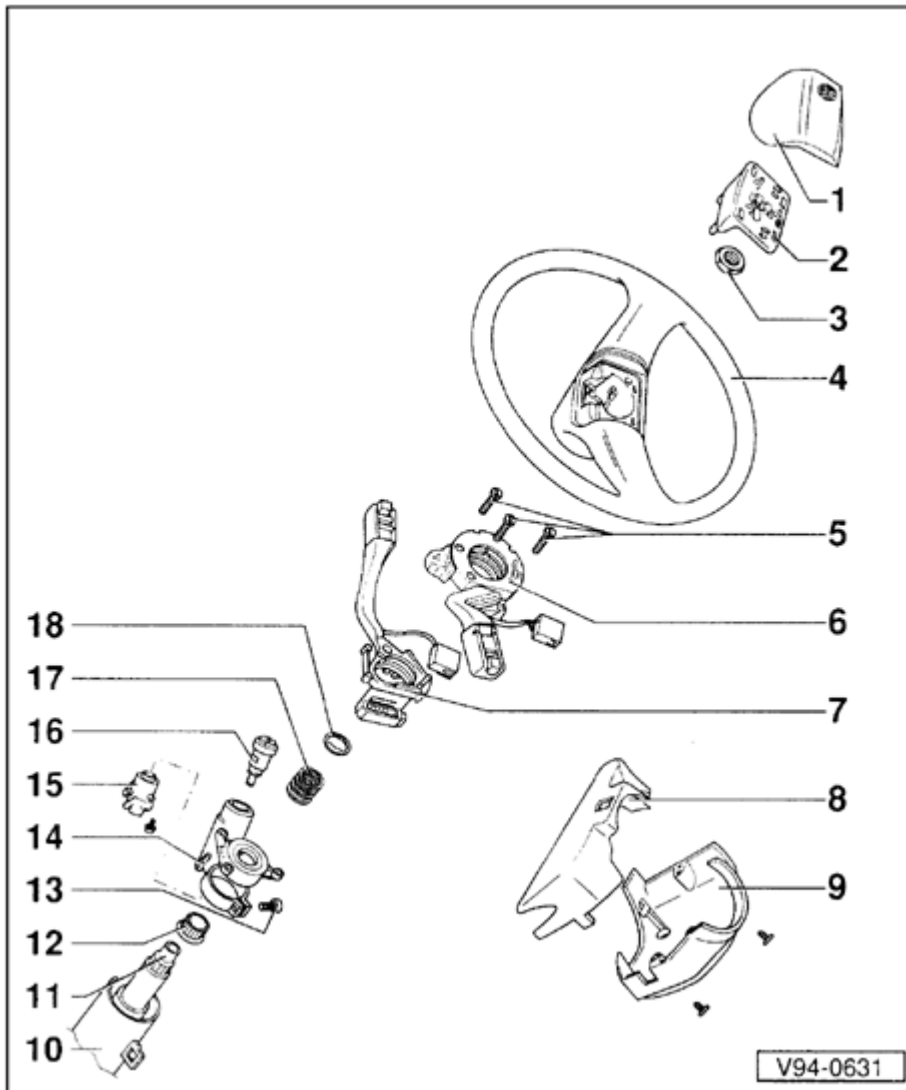
**1 - Horn pad**

◆ Removing

⇒ [1](#)**2 - Horn plate**◆ Removing
contact plate⇒ [2](#)**3 - Hex nut**◆ 70 Nm, (51 ft..
lb)**4 - Steering wheel**◆ Horn operation
contact ring⇒ [3](#)**5 - Steering column
switch securing
screws****6 - Turn signal/
cruise control
switch high and
low beam,
headlight flasher
and emergency
light switch**

◆ Removing

⇒ [page 94-27](#)

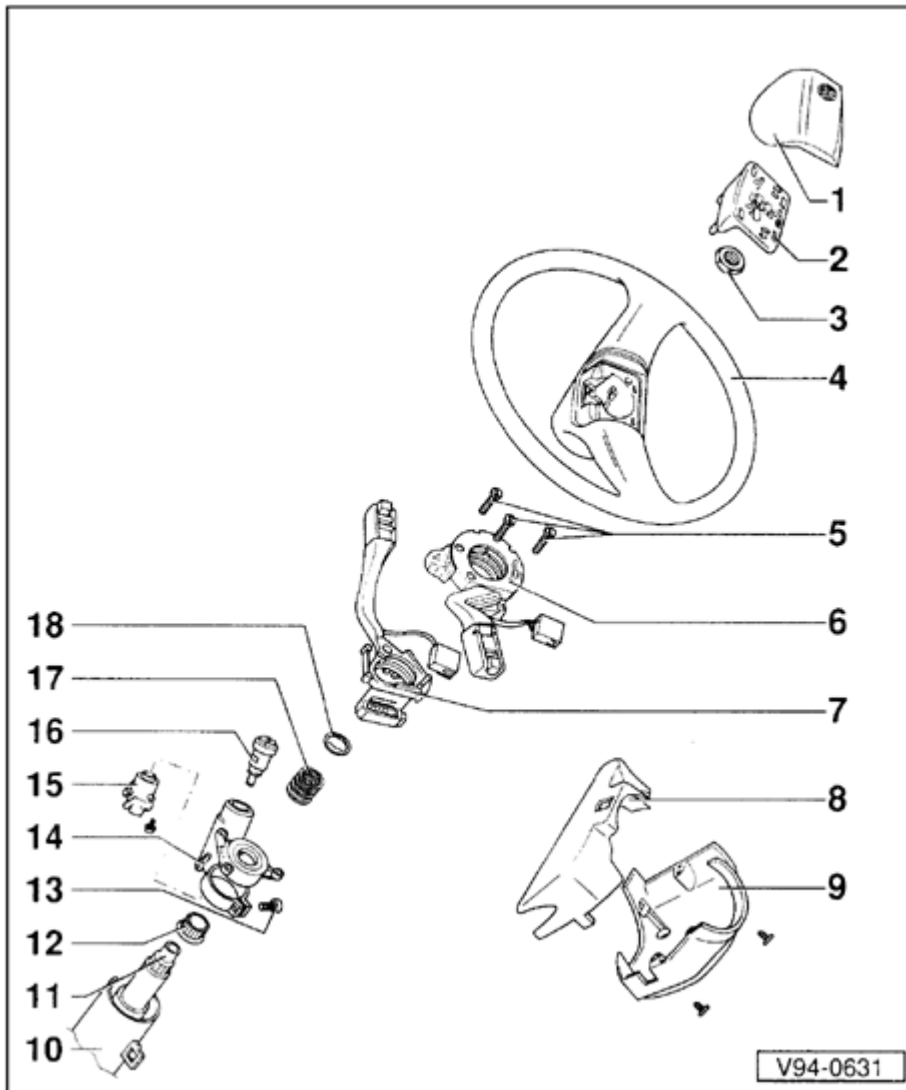

7 - Windshield wiper, wiper/wash operation and multi-function indicator switch

◆ Removing

⇒ [page 94-27](#)

8 - Upper steering column trim

9 - Lower steering column trim

10 - Column tube

11 - Steering column

12 - Support ring

13 - Steering column lock housing securing bolt

◆ 10 Nm, (7 ft. lb)

14 - Steering lock housing

◆ Removing and installing

⇒ [page 94-31](#)

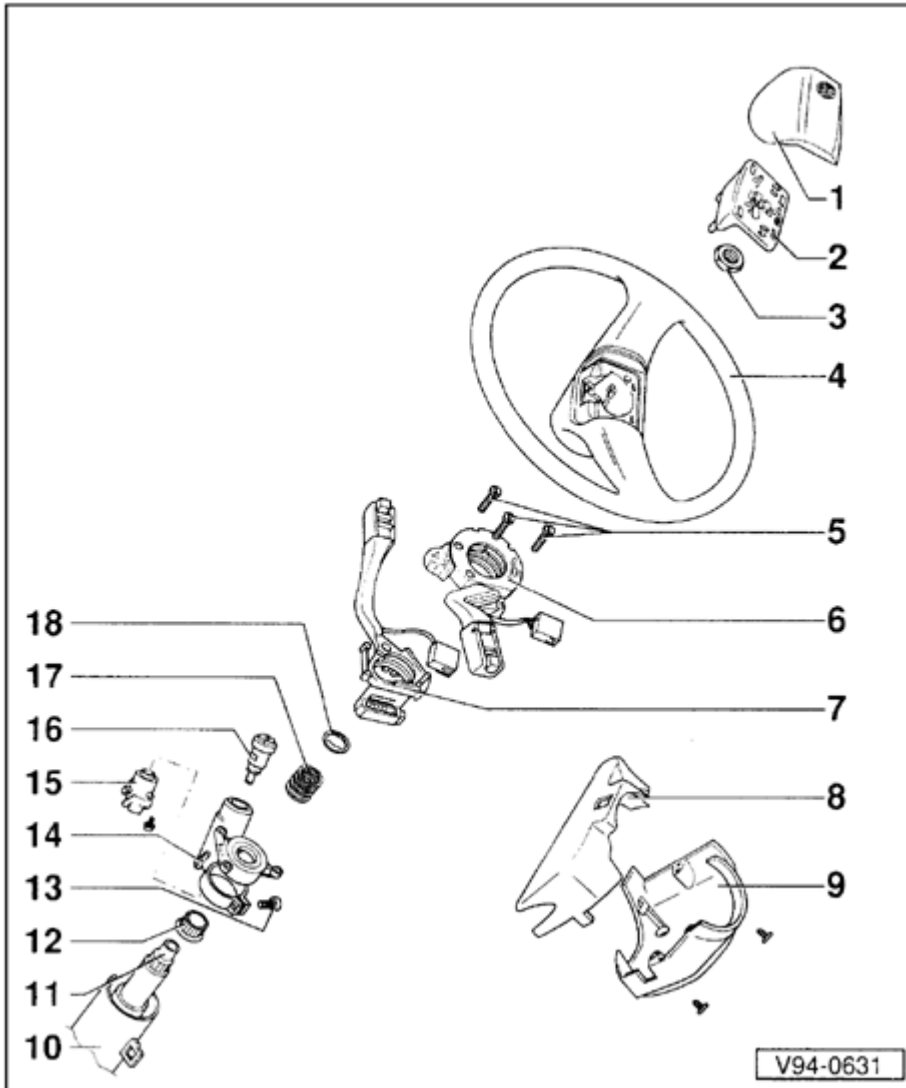

**15 - Ignition switch-
remove steering
lock housing,
then remove
securing screws**

16 - Lock cylinder

◆ Removing and
installing

⇒ [page 94-34](#)

17 - Spring

18 - Lock washer

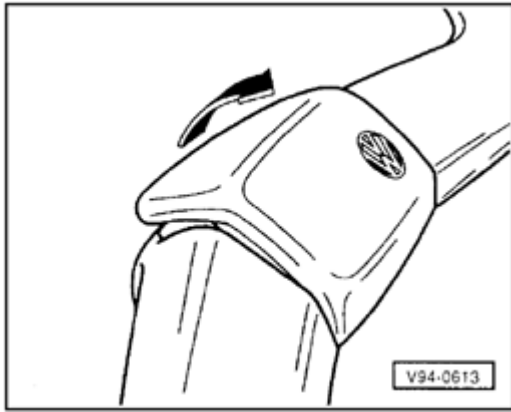

A

Fig. 1 Horn pad, removing

CAUTION!

Special safety precautions apply to vehicles equipped with Airbags ⇒ Repair Manual Body Interior, Repair Group 69 for airbag removal and handling instructions.

- Lift top of cover and pull off steering wheel in direction of arrow.

Note:

Under the cover there are three springs, which keep the cover and the contact plate separated ⇒ [Fig. 2](#) .

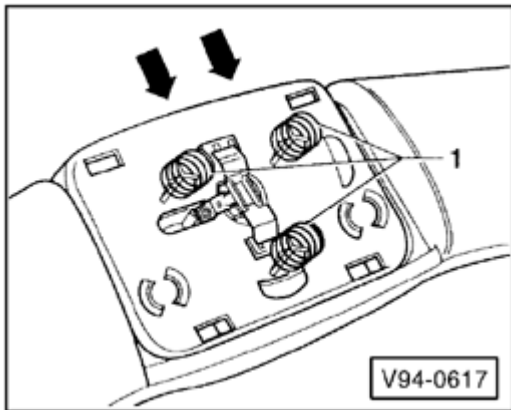

A

Fig. 2 Horn plate, removing

- Take springs -1- off contact plate.
- Press contact plate in direction of arrow and pull off steering wheel, upward.
- Pull off wiring connectors.

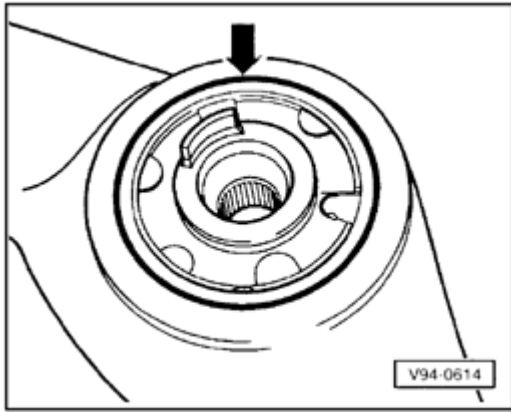

A

Fig. 3 Horn contact ring, operation

The positive voltage for operating the horn is supplied via a spring contact on the turn signal switch and a slip ring -arrow- under the steering wheel.

Grease with G 000 400 or equivalent.

Steering column switches, removing and installing

- Remove steering wheel.
- Remove trim lower part.
- Remove securing screws -arrows-.
- Separate connectors to switches.
- Pull switches together with upper trim from steering column.

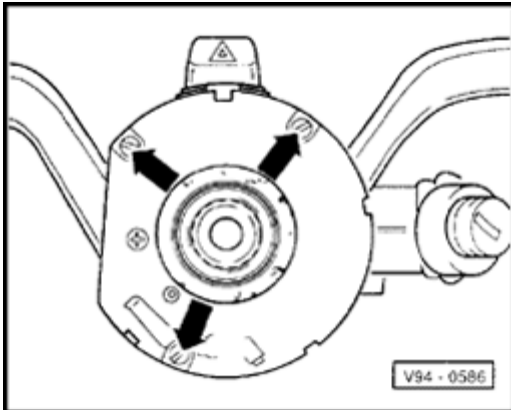

Electrical connections for steering column switches and ignition/starter switch, terminal assignments

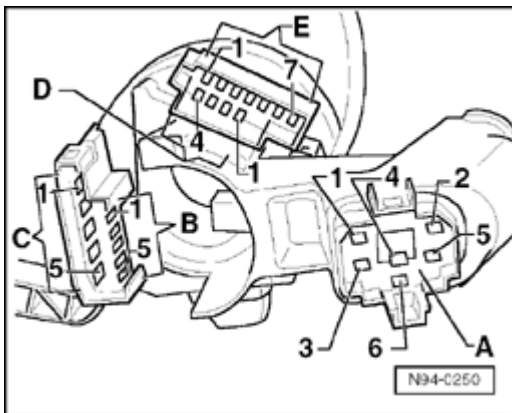

A - Ignition/starter switch

- 1 - Ignition/starter switch - Terminal 15
- 2 - Ignition/starter switch - Terminal X
- 3 - Ignition/starter switch - Terminal 50
- 4 - Ignition/starter switch - Terminal 30
- 5 - Ignition/starter switch - Terminal SU
- 6 - Ignition/starter switch - Terminal P

B - Connector, 5-pin

- 1 - Windshield wiper switch - Terminal 53b
- 2 - Windshield wiper switch - Terminal 53a
- 3 - Windshield wiper switch - Terminal 53
- 4 - Windshield wiper switch - Terminal 53e
- 5 - Windshield wiper switch - Terminal J

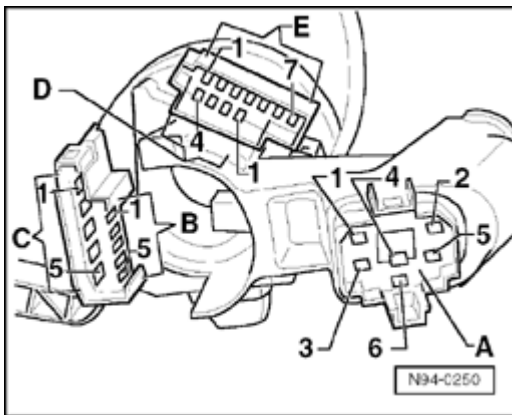

A C - Connector, 5-pin

- 1 - Hazard light switch - Terminal 49
- 2 - High beam/flasher switch - Terminal 56b
- 3 - High beam/flasher switch - Terminal 56
- 4 - High beam/flasher switch - Terminal 56a
- 5 - High beam/flasher switch - Terminal 30

D - Connector, 4-pin

- 1 - Windshield wiper switch - Terminal L
- 2 - Windshield wiper switch - Terminal T
- 3 - Windshield wiper switch - Terminal 31
- 4 - Hazard light switch - Terminal 15

E - Connector, 7-pin

- 1 - Horn operation - Terminal 71
- 2 - Hazard light switch - Terminal 49a
- 3 - Turn signal switch - Terminal L
- 4 - Parking light switch - Terminal PL
- 5 - Parking light switch - Terminal P
- 6 - Parking light switch - Terminal PR
- 7 - Turn signal switch - Terminal R

Electrical connections for Multi-function indicator (MFI)* and cruise control system (CCS) switches, terminal assignments

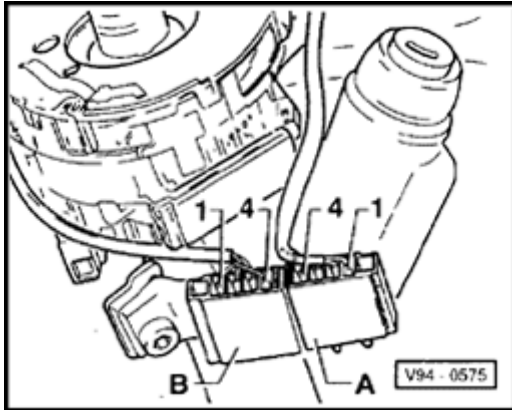
**A**

A - Connector, 4-pin MFI switch

- 1 - Terminal 31
- 2 - Function (Mode)
- 3 - Memory selection switch (Memory)
- 4 - Cancel (Reset)

B - Connector, 4-pin, cruise control switch

- 1 - On
- 2 - Resume
- 3 - Memory (FIX)
- 4 - Terminal 15

*) Where applicable

Steering lock housing, removing and installing

Removing

- Remove steering column switches ⇒ [page 94-27](#)
- Drill out steering lock housing securing bolts.
- Pull lock washer and spring off steering column.

Note:

Pull steering column down and away after removing the lock washer.

- Remove steering lock housing from column tube and steering column.

Installing

Note:

Installation of the steering lock housing can only be undertaken when the steering column has been removed

⇒ *Repair Manual, Suspension, Wheels, Brakes, Steering, Repair Group 48*

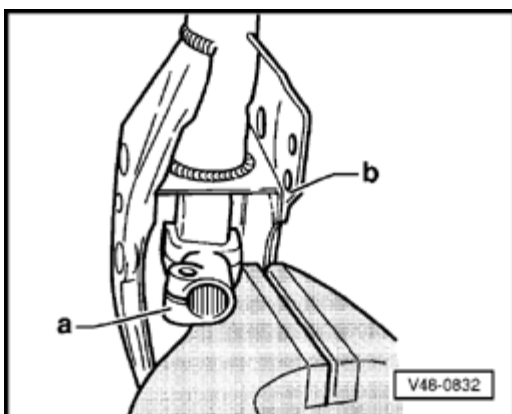

A

- Place column tube in vice ensuring that the universal joint -a- is supported on the vice.
- Secure column in vice.
- Place steering lock housing on column tube.

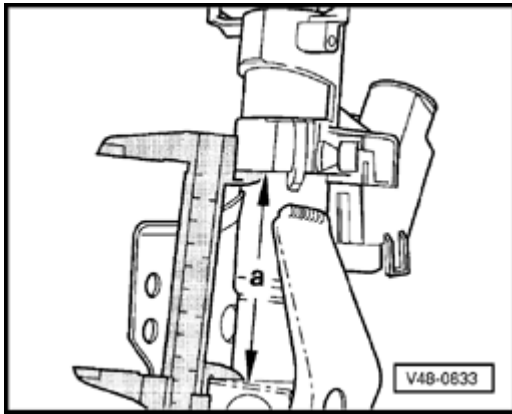

A

- Push steering lock housing onto the column tube until dimension -a- is attained.

a = 95 mm (3.7 in.)

- Tighten steering lock housing shear bolt until the head shears off.
- Slide spring and lock washer on steering column.

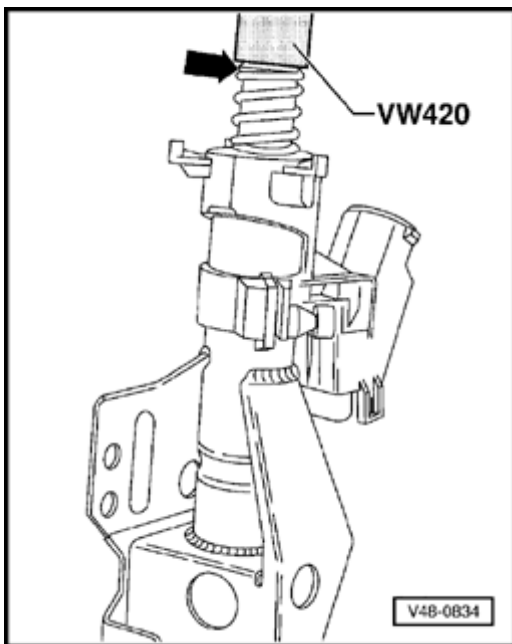

A

- Drive lock washer onto steering column using special tool VW 420 until the installation position is reached.

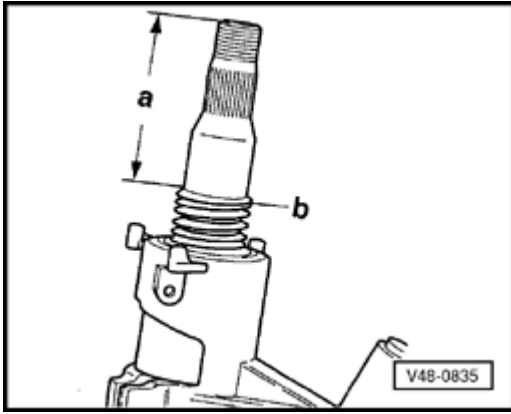

◀ Lock washer installation position

a = 65 mm (2.5 in.)

b = lock washer position

Lock cylinder, removing and installing

Removing

- Removing steering lock housing ⇒ [page 94-31](#)

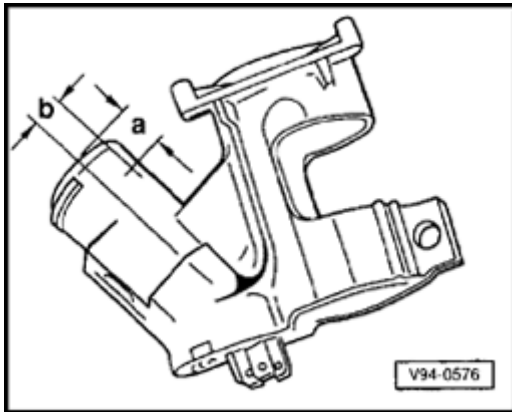

A

- Mark steering lock housing for drilling
 - a - 12 mm (.5 in.)
 - b - 10 mm (.4 in.)
- Drill steering lock housing (approx. 3 mm, (.12 in.)), until the lock cylinder spring is evident (hole depth approx. > 3 mm, (.12 in.)).
- Using opposite end of drill compress lock spring and pull out lock cylinder.

Installing

CAUTION!

The original steering lock housing must not be reinstalled.

- Push lock cylinder into steering lock housing.
- By slightly turning key in lock cylinder it can be pushed onto the stop.